

Whitefield is located 44° 12' N and 69° 35' W. It has 29,856 land acres, 269 water acres and 38 acres in bog and swamp. Total = 30,125. The highest point is Hill Hill @ 410'. Near Joys Pond, lowest point is the Sheepscot River near Alna line @ 20'.

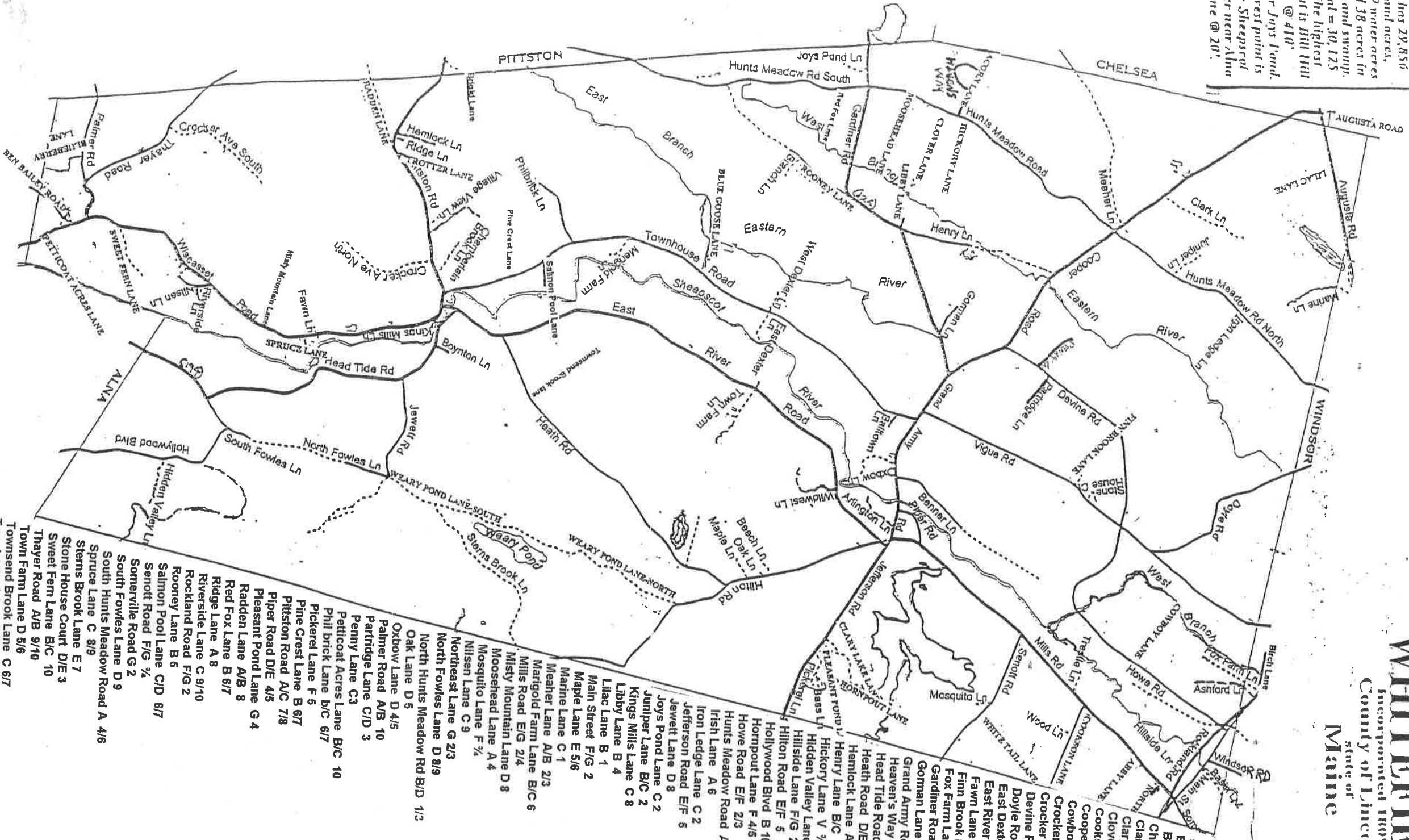

**WHITEFIELD**  
 Incorporated 1899  
 County of Lincoln  
 State of  
**MAINE**

- Abby Lane F/G 3
- Acorn Lane A/4
- Arlington Lane D/E
- Ashford Lane F/2
- Augusta Road B/1
- Balktown Lane E/5
- Basin Lane G/4-5
- Bass Lane F/G 4-5
- Beech Lane E 5
- Ben Bailey Road B 10
- Benner Lane D/E 4
- Birch Lane G 1/2
- Blueberry Lane B 10
- Blue Goose Lane B 5/5
- Boynkon Lane C 7/8
- Branch Lane B 5
- Brigid Lane A 7
- Chamberlain Brook Lane B/C/7 8
- Clark Lane B 2
- Chary Lake Lane F 4/5
- Clover Lane A/B 4
- Cookson Lane F/G 3
- Cooper Road B/C 2/3
- Cowboy Lane F 2/3
- Crocker Avenue North B/C 8
- Crocker Avenue South A 9
- Devine Road D 3
- Doyle Road E 2
- East Dexter Lane C 5
- East River Road C/E 5/7
- Fawn Lane C 8/9
- Finn Brook Lane D 3
- Fox Farm Lane F/G 2
- Gardiner Road A/C 4
- Gorman Lane C 4
- Grand Army Road D/E 4
- Heaven's Way Lane
- Head Tide Road C/D 8/9
- Heath Road D/E 6/7
- Hemlock Lane A/B 7/8
- Henry Lane B/C 4
- Hickory Lane V 1/2
- Hidden Valley Lane D 10
- Hillside Lane F/G 2/3
- Hilton Road E/F 5
- Hollywood Blvd B 10
- Hornput Lane F 4/5
- Howe Road E/F 2/3
- Hunts Meadow Road A/B 1/2
- Irish Lane A 6
- Iron Ledge Lane C 2
- Jefferson Road E/F 5
- Jewett Lane D 8
- Joys Pond Lane C 2
- Juniper Lane B/C 2
- Kings Mills Lane C 8
- Libby Lane B 4
- Lilac Lane B 1
- Main Street F/G 2
- Maple Lane E 5/6
- Marine Lane C 1
- Weather Lane A/B 2/3
- Margold Farm Lane B/C 6
- Mills Road E/G 2/4
- Misty Mountain Lane D 8
- Moosehead Lane A 4
- Mosquito Lane F 1/2
- Nilsen Lane C 9
- Northeast Lane G 2/3
- North Fowles Lane D 8/9
- North Hunts Meadow Rd B/D 1/3
- Oak Lane D 5
- Oxbow Lane D 4/5
- Palmer Road A/B 10
- Partridge Lane C/D 3
- Penny Lane C 3
- Petticoat Acres Lane B/C 10
- Phil brick Lane b/c 6/7
- Pickereel Lane F 5
- Pine Crest Lane B 6/7
- Pittston Road A/C 7/8
- Piper Road D/E 4/5
- Pleasant Pond Lane G 4
- Radden Lane A/B 8
- Red Fox Lane B 6/7
- Riverside Lane C 9/10
- Rockland Road F/G 2
- Rooney Lane B 5
- Salmon Pool Lane C/D 6/7
- Senott Road F/G 1/2
- Somerville Road G 2
- South Fowles Lane D 9
- South Hunts Meadow Road A 4/6
- Spruce Lane C 8/9
- Sterns Brook Lane E 7
- Stone House Court D/E 3
- Sweet Fern Lane B/C 10
- Thayer Road A/B 9/10
- Town Farm Lane D 5/6
- Townsend Brook Lane C 6/7
- Townhouse Road B/C 4/7
- Trotter Lane A/8
- Trestle Lane F 3
- Vigue Road D/E 2/4
- Village View Lane B/C 7/8
- Weary Pond Lane - North F 6
- Weary Pond Lane - South E 7/8
- West Dexter Lane C 5
- White Tail Lane G 4
- Wild West Lane D/E 5
- Windsor Road F/G 2
- Wiscasset Road B/C 8/10
- Wood Lane F/G 3

A B C D E F G

1 2 3 4 5 6 7 8 9 10

1 2 3 4 5 6 7 8 9 10